

LEILIGHET  
**305**

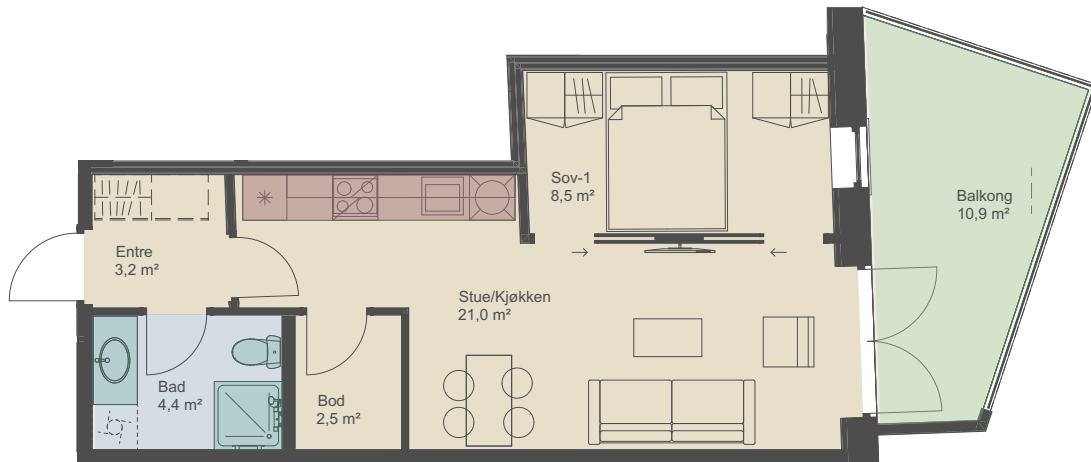

ANTALL ROM	2
AREAL BRA	41,5 m <sup>2</sup>
AREAL P-ROM	38,4m <sup>2</sup>
BOD KJELLER	5,0 m <sup>2</sup>
BALKONG AREAL	10,9 m <sup>2</sup>
BALKONGTYPE	Overbygd og delvis innglasset